

## For specialist staff only: Destruction-free maintenance

### ▲ **WARNING!** Acute risk of injury!

Electrical components (e.g. motor and power cord) may only be repaired by SEVERIN customer service. To this purpose, send in the appliance. Service address; see reverse.

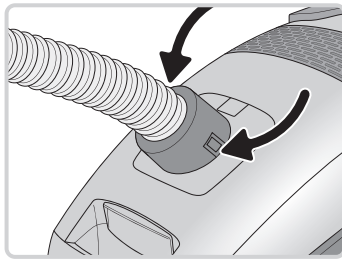

#### **Suction hose and suction hose inlet:**

Release the suction hose by pressing the unlocking button (see fig./arrow). Check the suction hose and suction hose inlet for possible dirt and remove any you find. Replace a damaged suction hose with a new one. The suction hose and suction hose inlet cannot be maintained any further than that. Dispose of the worn-out suction hose with the domestic refuse.

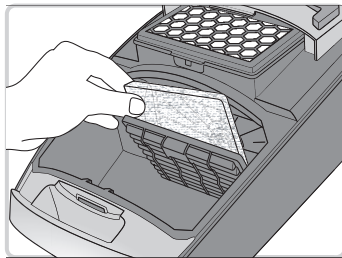

#### **Dust bag**

You can dispose of the full dust bag with the domestic refuse as long as it does not contain any dirt that is not permitted in domestic refuse. Order new dust bags using the order number shown below (see fig.).

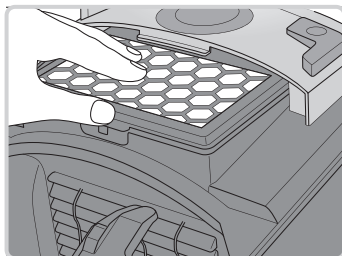

#### **Motor protection filters and exhaust filters:**

Dismantle the filters as shown (see fig.). Clean the filters if they are only contaminated and are not deformed or damaged. Deformed or damaged filters must be replaced with new ones immediately (see fig.). Dispose of worn-out filters with the domestic refuse.

#### **Housing:**

If necessary, clean the housing and dust compartment with a slightly moistened cloth. If the housing should get damaged, the appliance must be repaired by SEVERIN customer service. To this purpose, send in the appliance. Service address; see reverse.

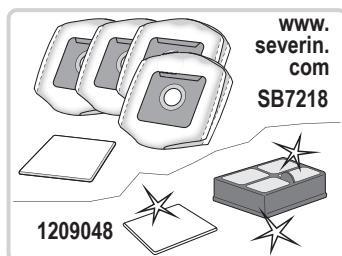

## For specialist staff only: Dismantling and disposal

At the end of its service life, the appliance must be disassembled and recycled.

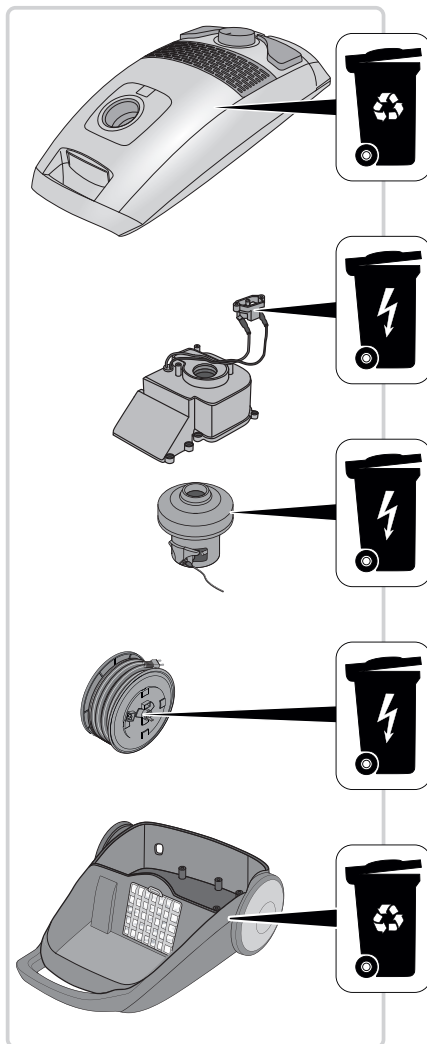

Loosen all screw connections and other connections until the appliance components can be disposed of separately as follows:

**With the recyclable commercial refuse (see fig./ ):**

- Upper housing shell
- Lower housing shell
- Hubcaps
- All small PVC parts
- Screws

**With the recyclable electronic waste (see fig./ ):**

- Motor
- Cable drum
- Circuit board
- Wires

### Service information

## **SEVERIN SERVICE**

Röhre 27 (Halle 10)  
59846 Sundern  
Telefon (02933) 982-460  
service@severin.de

according to EU Directive No. 666/2013 (Appendix 1, Para. 2(b))