

# TRENDnet<sup>®</sup>



## Quick Installation Guide

TI-PG102i

# Table of Contents

---

## **1 English**

1. Before You Start
2. Quick Reference
3. Hardware Installation
4. Hardware Configuration
5. Additional Information

# 1. Before You Start

---

## Package Contents

- TI-PG102i
- Quick Installation Guide
- Removable terminal block
- DIN-rail mount

## Minimum Requirements

- Power supply (ex. model TI-S24048, TI-S48048, TI-S12024)
- Networked computer
- RJ-45 Network Cable

## Optional Equipment

- 35 mm DIN-Rail

# 2. Quick Reference

---

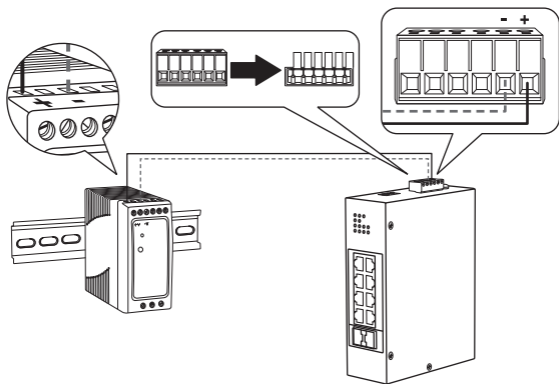

### 3. Hardware Installation

#### **Note:**

The TI-PG102i can be placed on a desktop, wall, or mounted to a DIN-Rail.

#### **DIN-rail Mounting Instructions**

1. Attach the DIN-Rail mount to TI-PG102i.

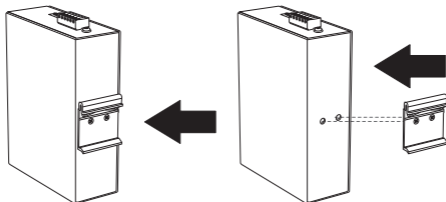

2. Position the unit in front of the DIN-Rail and hook the mount bracket over the top of the rail.
3. Rotate the TI-PG102i downward towards the rail to lock it into place. You will know it is secure when you hear the click.

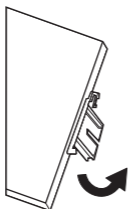

**Mounting the unit**

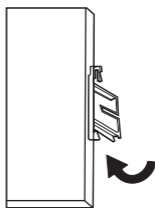

**Releasing the unit**

4. To remove the unit, pull down to clear the bottom of the DIN-Rail and rotate away from the rail.

## 4. Hardware Configuration

1

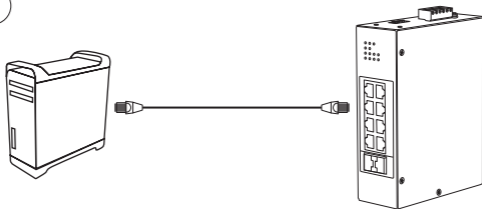

2. Assign a Static IP address to your computer's network adapter in the subnet of 192.168.10.x (e.g. 192.168.10.25) and a subnet mask of 255.255.255.0.
3. Open your web browser, type the IP address of the switch in the address bar, and then press **Enter**.  
The default IP address is 192.168.10.200
4. Enter the **User name** and **Password**, and then click **Login**. By default:

User Name: **admin**

Password: **admin**

**Note:** User Name and Password are case sensitive.



5. Click **Basic Settings** and then click **General Settings**.



6. Configure the switch to match the requirements of your network. Then click **Apply**.

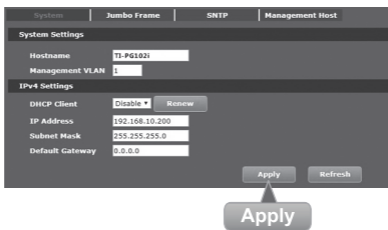

7. Click **Save**.

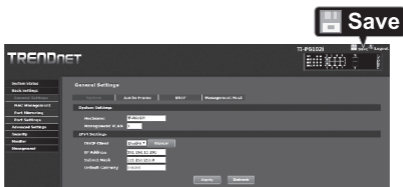

8. Connect a network source and devices to the switch. Check the LEDs to confirm the connections are established. Your installation is complete.

## Applying Power

1. Connect the power supply (sold separately) to the included terminal block (as shown below) and secure with the screws.

**Note:** Polarities must match.

2. Attach the terminal block to the unit.

**Optional:** The switch chassis can also be connected to a known grounding point for additional safety and protection (grounding wire is not included)

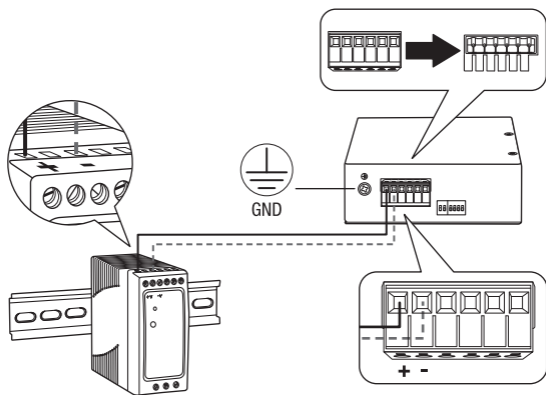

## Safety Note



- Turn off the power before connecting any module or wire. The correct power supply voltage (24 – 57 V DC) is listed on the product label. Check the voltage of your power source to make sure that you are using the correct part. Do NOT use voltage greater than 24 – 57 V DC, as specified on the product label.
- Calculate the maximum possible current in each power wire and common wire. Observe all electrical codes dictating the maximum current allowable for each wire size. If the current surpasses the maximum ratings, the wiring could overheat, causing serious damage to your equipment.



## 5. Additional Information

### 1. Redundant power inputs

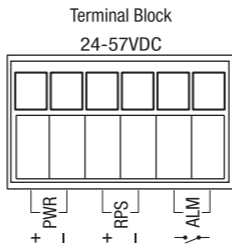

**Redundant Power Input:** “Terminal Block (PWR)” as primary power and “Terminal Block (RPS)” for secondary power source, to be a redundant power Input.

## 2. DIP Switch



Switch	Status	Function
1	OFF	Disable alarm relay for PWR power input
	ON	Enable alarm relay for power failure on PWR power input
2	OFF	Disable alarm relay for RPS power input
	ON	Enable alarm relay for power failure on RPS power input
3	OFF	Storm control managed by switch configuration
	ON	Enable storm control (Broadcast and DLF rate set to 300pps) Takes precedence over storm control switch configuration
4	OFF	802.1p QoS managed by switch configuration
	ON	Enable 802.1p QoS on ports 1 and 2 (Set CoS priority to tag 4 on ports 1 and 2) Takes precedence over 802.1p QoS switch configuration
5	OFF	Port 9 SFP set to Gigabit speed full duplex
	ON	Port 9 SFP set to 100Mbps speed full duplex
6	OFF	Port 10 SFP set to Gigabit speed full duplex
	ON	Port 10 SFP set to 100Mbps speed full duplex

### 3. LED Indicators

LED	Status	Function
PWR	OFF	Terminal block PWR failure or disconnected
	ON	Terminal block PWR is connected
RPS	OFF	Terminal block RPS failure or disconnected
	ON	Terminal block RPS is connected
ALM (Red)	OFF	No alarm setup
	ON	PWR/RPS failure or disconnected
PoE (Ports 1 – 8)	OFF	No PoE power supplied
	ON	PoE power is supplied to connected device
10/100/ 1000Mbps (Ports 1 – 8)	OFF	Link speed established at 10Mbps or 100Mbps
	ON	Link speed established at 1000Mbps
LINK/ACT (Ports 1 – 8)	OFF	No link/port is disconnected
	ON	Port connection is established
	Blinking	Data transmission
SFP 9-10	OFF	No link/SFP is disconnected
	ON	SFP link is established
	Blinking	Data transmission

**Note:** To download the latest version of the user's guide, please go to <http://www.trendnet.com/support> and select the **TI-PG102i** within the Products Download dropdown list.

# Declaration of Conformity

TRENDNET<sup>®</sup>

## Manufacturer's Name and Address

TRENDnet, Inc.  
20675 Manhattan Place  
Torrance, CA 90501 USA

Zwolsestraat 156 2587 WB  
The Hague The Netherlands



## Product Information

**Model Number:** TI-PG102i  
**Product Name:** 10-Port Industrial Gigabit L2 Managed PoE+ DIN-Rail Switch 24 – 57V  
**Trade Name:** TRENDnet

TRENDnet hereby declare that the product is in compliance with the essential requirements and other relevant provisions under our sole responsibility.

**EMC:** EN 55032: 2015 + AC: 2016 (Class A)  
EN 55024: 2010 + A1: 2015  
EN 61000-4-2: 2009  
EN 61000-4-3: 2006 + A1: 2008 + A2: 2010  
EN 61000-4-4: 2012  
EN 61000-4-5: 2014  
EN 61000-4-6: 2014 + AC 2015  
EN 61000-4-8: 2010

**Energy Efficiency** Regulation (EC) No. 1275/2008, No. 801/2013

This product is herewith confirmed to comply with the Directives.

**Directives:** EMC Directive 2014/30/EU  
RoHS Directive 2011/65/EU  
REACH Regulation (EC) No. 1907/2006

Person responsible for this declaration.

Place of Issue: Torrance, California, USA

Date: September 13, 2018

Name: Sonny Su

Title: Director of Technology

Signature: \_\_\_\_\_

A handwritten signature in black ink, appearing to read 'Sonny Su', is written over a horizontal line.



## Certifications

This device complies with Part 15 of the FCC Rules.

Operation is subject to the following two conditions:

- (1) This device may not cause harmful interference.
- (2) This device must accept any interference received. Including interference that may cause undesired operation.



Waste electrical and electronic products must not be disposed of with household waste. Please recycle where facilities exist. Check with your Local Authority or Retailer for recycling advice.

## Technical Support

If you have any questions regarding the product installation, please contact our Technical Support.

Toll free US/Canada: **1-866-845-3673**

Regional phone numbers available at [www.trendnet.com/support](http://www.trendnet.com/support)

## TRENDnet

20675 Manhattan Place  
Torrance, CA 90501  
USA

**Applies to PoE Products Only:** This product is to be connected only to PoE networks without routing to the outside plant.

## Note

The Manufacturer is not responsible for any radio or TV interference caused by unauthorized modifications to this equipment. Such modifications could void the user's authority to operate the equipment.

## Advertencia

En todos nuestros equipos se mencionan claramente las características del adaptador de alimentación necesario para su funcionamiento. El uso de un adaptador distinto al mencionado puede producir daños físicos y/o daños al equipo conectado. El adaptador de alimentación debe operar con voltaje y frecuencia de la energía eléctrica domiciliar existente en el país o zona de instalación.

## Product Warranty Registration

Please take a moment to register your product online. Go to TRENDnet's website at: [www.trendnet.com/register](http://www.trendnet.com/register)