

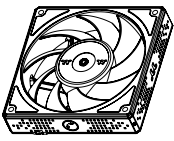

## Parts List



**A** x 3  
Fan



**B** x 1  
Controller

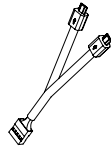

**C** x 1  
Controller Cable



**D** x 1  
Bridge Cable

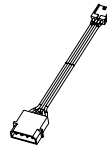

**E** x 1  
Power Cable



**F** x 12  
Short Screw



**G** x 12  
Long Screw

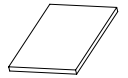

**H** x 1  
Velcro

## Installation Guide

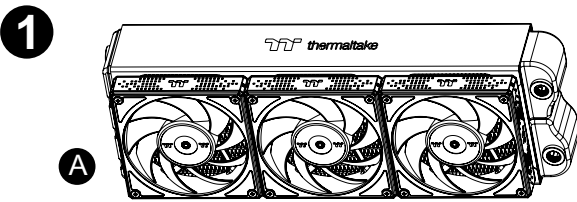

Install the fans properly onto the radiator.

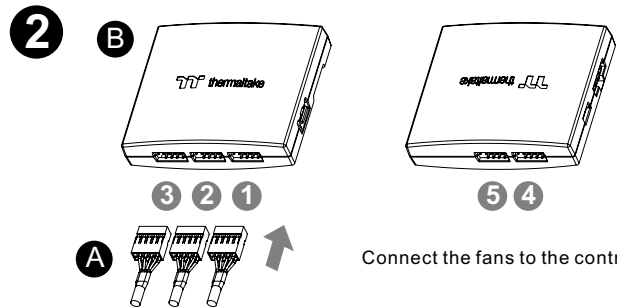

Connect the fans to the controller.

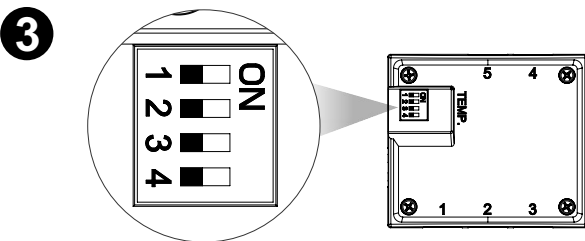

Set the DIP switch on the back side of the controller to assign the number of the controller

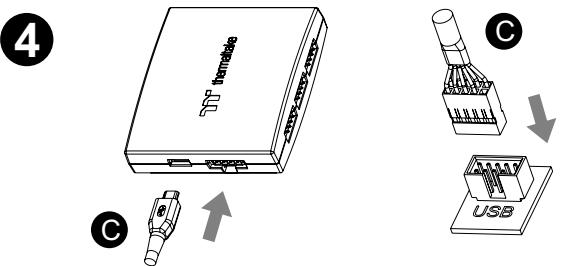
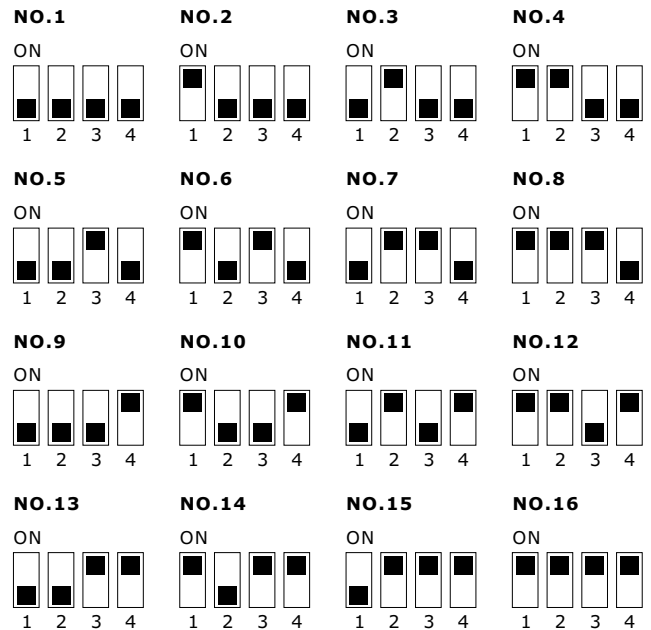

Connect the controller cable onto the motherboard (USB 2.0 9 pin) and controller.

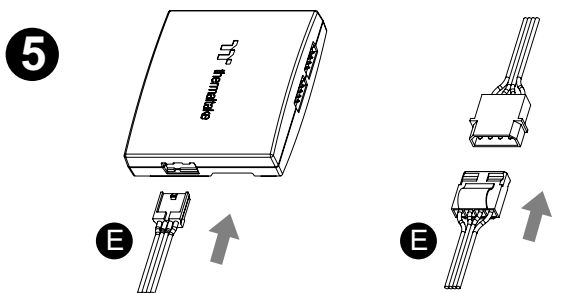

Connect the power cable to the 4pin Molex connector and controller.

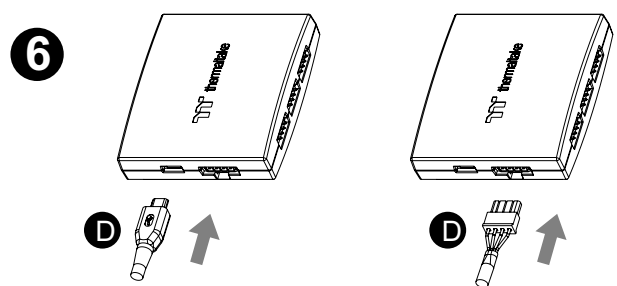

If you want to connect two or more controllers, you can sync the controllers with the bridge connector.

# TT RGB Plus Software control interface

Please download TT RGB PLUS from Thermaltake's Official website.

<https://www.thermaltake.com/downloads>

OS compatibility: Windows 10, Windows 11

## TOUGHFAN RGB Radiator Fan Software User Interface

### CONNECT - CONTROLLER



- After installation of TT RGB PLUS, you can find controllers on the "CONNECT" & "CONTROLLER" page.
- Click the controller port to make the "TOUGHFAN RGB" fan glow red lighting to pair.
- Drag and drop to pair the "TOUGHFAN RGB" fan with controller port.
- SAVE:** Save the controller pairing settings.  
**RESET:** Reset the controller pairing.  
**RESCAN:** Rescan the controllers.

### MY PC - FAN SPEED

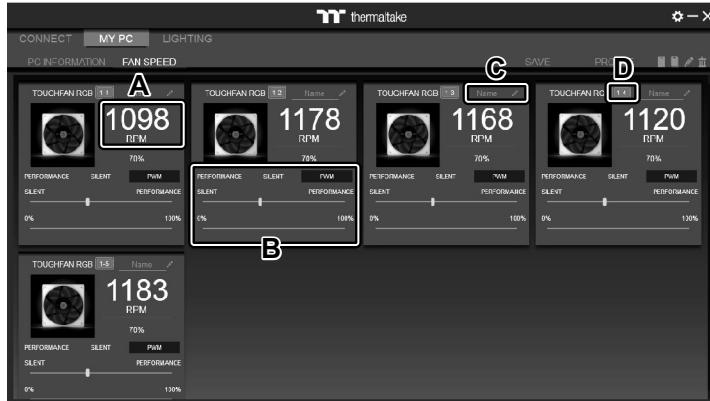

TOUGHFAN RGB Radiator Fan Speed Information and PWM Performance Settings.

- TOUGHFAN RGB real-time fan speed.
- Fan speed settings
  - PERFORMANCE: 0% → 100% (1500rpm)
  - SILENT: 0% (300~500rpm)
  - PWM: Set PWM silent (50%) to PWM performance (100%).
- NAME: Edit the case fan name.
- Controller – Port number.

### LIGHTING

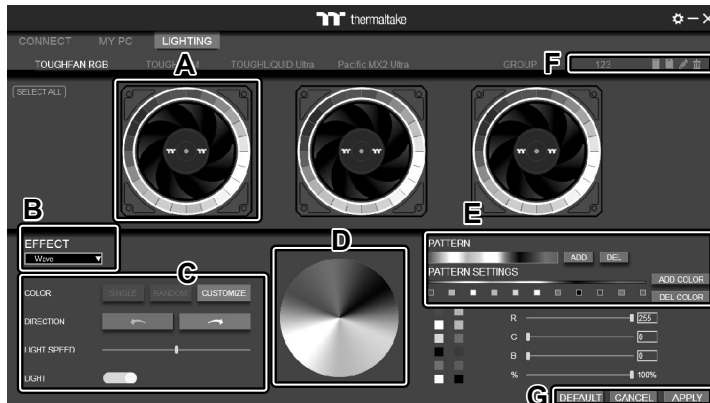

- Preview and edit the lighting effect.
- Select 23 Lighting Effects.
- Lighting effect settings.
- Color palette: select lighting color
- PATTERN: Set up the color pattern ring.
- Profile Settings: New, Copy, Edit, Delete
- DEFAULT: Reset the lighting effects.  
**CANCEL:** Deselect the LEDs for the preview screen.  
**APPLY:** Execute and store lighting effects.



The software interface may vary with feature updates, please download the latest software version from [www.thermaltake.com](http://www.thermaltake.com)